

Development of “Physical Glasses” that can remotely support the assessment of visiting nurses

EMIKO SHINOZAKI (R.N.,Ph.D.) , CHIHARU ITO (R.N.,Ph.D.) , YOSHINORI TAMENAGA (R.N.,M.N.) ,
RYOSUKE BAN (R.N.,Ph.D.) , UTAKO SASAKI (R.N.,M.N.)

University of Human Environments Graduate School, Department of Nursing Research, Japan

Introduction

Japan has become a super aging society ahead of other countries. Therefore, establishing a community-based integrated care system is critical to address problems related to the aging population. Visiting nurses can have significant role in aiding elderlies. However, there are issues such as the aging of home visiting nurses and a shortage of human resources.

Physical Glasses can provide remote support from expert nurses.

When the visiting nurse puts on the glasses and looks at the in-home patient, one eye sees the actual scene, and the other sees patient's information on the screen that is shared by a remotely located expert nurse. An expert nurse can remotely show texts or pinpoint object on the screen. It is also possible for the visiting nurse to communicate with the expert nurse through a microphone from a remote location.

As a result, home visiting nurses' "anxiety about making assessments by themselves" will be alleviated, and it will be possible to provide education, leading to improved assessment. However, problems such as the weight of the glasses and the temperature rise of the glasses due to long-term use became clear, and need to be improved in the future.

ACKNOWLEDGEMENTS

We wish to acknowledge the participants who replied three times to the questionnaires. This work was supported by Grant-in-Aid for Scientific Research (C) (19592474).

Purpose

In this study we developed “Physical Glasses” that can provide remote support from expert nurses to visiting nurses in patient physical assessments.”Physical Glasses” is equipped with remote support technology in smart glasses.

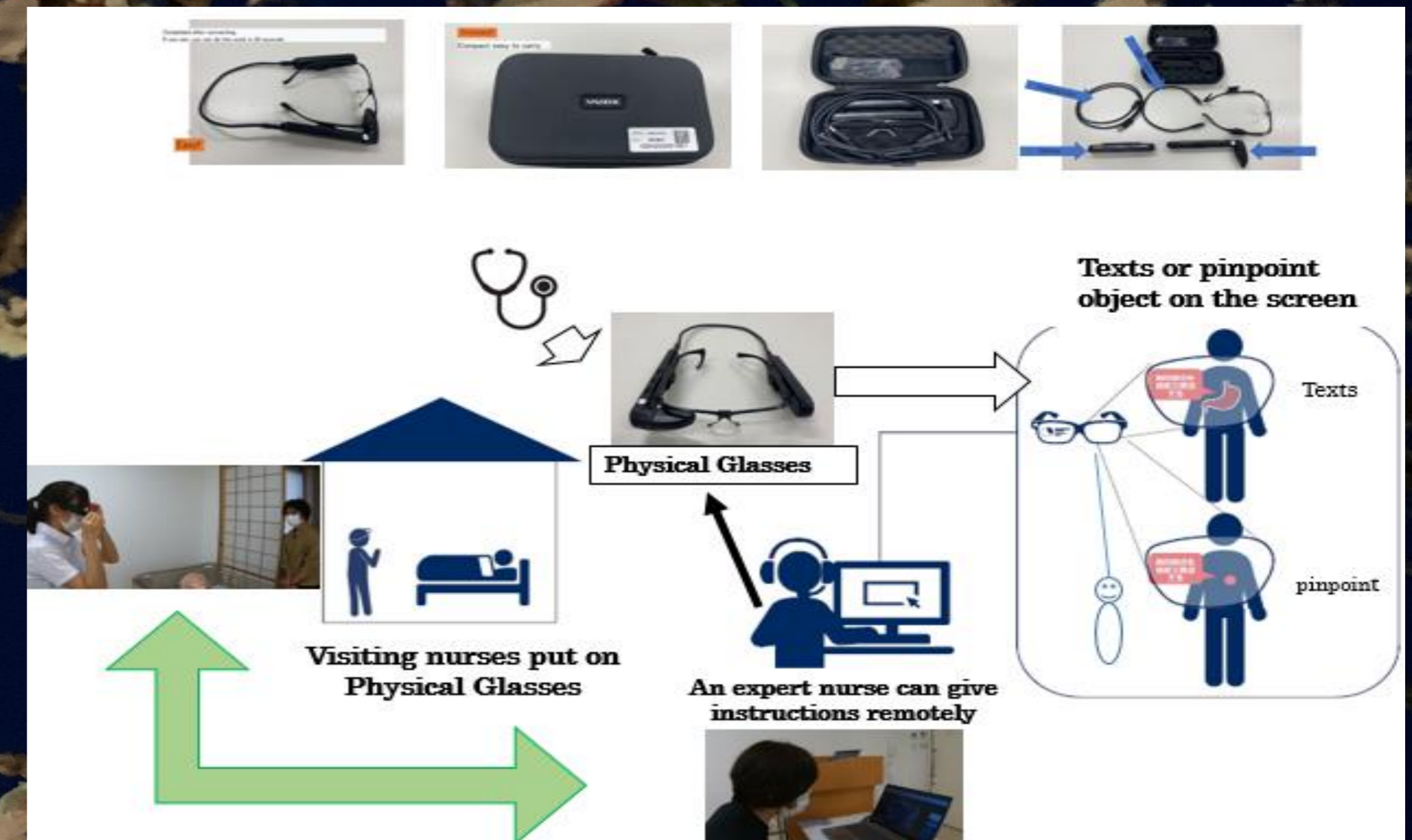

Contact Details

EMIKO SHINOZAKI R.N,Ph.D

Emai:e-shinozaki@uhe.ac.jp

3-220,Ebata cho,Obu city,Aichi,4740035,JAPAN

